

PLEASE READ BEFORE INSTALLATION

Comprehensive Installation and Maintenance Instructions

It is important to **work out of several cartons to mix the patterns** when installing this select flooring product to enhance the beauty of nature without having duplicate planks beside each other. This product offers the natural colors and texture variations that are abundantly available in nature to give a beautiful finished installation within the home. This product should never be installed outdoors, or in areas that will not constantly stay between 23° F and 140° F.

BEFORE YOU BEGIN INSTALLATION, it is extremely important that subfloor preparations are performed as follows:

SUBFLOOR:

1. Subfloor must be **level, flat, and structurally sound**. The subfloor levelness must not exceed 1/8" level within a 6' span in all directions. It is suggested to use either a level or a straightedge. Grind high spots down and level low spots with a water resistant non-shrinking Portland leveling compound. Be certain the floor joists do not impede the floor flatness as required. Unevenness can cause problems with the integrity of the locking system and cause the system to disengage.
2. Concrete substrates must be fully cured before installation for a minimum of 30 days or more. Concrete subfloors must be dry, smooth, and free from dust, solvent, wax, asphalt sealing compounds, and other materials that may compromise the backing of the flooring.
3. Underlayment with cushioning properties may not be used under this product under any circumstances, as the products have an attached IXPE pad.
4. It is the installer's responsibility to be certain the subfloor guidelines are followed before installation begins.

This product may be installed above, on, or below grade over **ACCEPTABLE SUBFLOOR TYPES:**

1. Concrete slab
2. APA Rated plywood underlayment
3. Properly prepared gypsum cement.
4. Underlayment grade particleboard
5. OSB minimum 3/4"
6. Existing Hardwood floor
7. Ceramic Tile
8. Single layer resilient tile and sheet vinyl (Floating or fiber back cushion vinyl products are not recommended)
9. Existing hard surface floor covering must be securely fastened

Waterproof Click Installation & Maintenance

WARNING: Existing resilient floor coverings and black asphalt adhesive may contain asbestos. Improper removal procedures could release asbestos fibers into the air. Asbestos fibers, when inhaled, could cause serious bodily harm. Do not sand or dry scrape these materials. If removal of existing floor coverings is necessary, be certain that all precautions are taken and proper procedures are followed. For information regarding proper removal procedures in the U.S.A., please consult the Resilient Floor Covering Institute (966 Hungerford Drive, Suite 12-B, Rockville, MD 20850) for a pamphlet, "Recommended Work Practices for the Removal of Resilient Floor Coverings."

GENERAL GUIDELINES:

ACCLIMATION: HVAC system for the installation must be operational and turned on to provide a temperature of 50-85°F. The product does not have to be acclimated, but it must be the same temperature as the room before installation.

DIRECT SUNLIGHT: The installed flooring should be protected from excessive exposure to direct sunlight.

CRAWL SPACE: The bottom of wooden subfloor joists must be a minimum of 18" above ground surface. Minimum 6 mil black poly sheeting must be in place covering 100% of the ground and overlapped a minimum of 6" at seams acting as a moisture barrier. The poly sheeting must run up the walls no less than 6". Air vents must be open on all sides with no less than 1.5% air vent opening compared to the total crawlspace area.

RADIANT HEAT: Only embedded radiant heat is recommended. Temperature should be reduced three days before installation to no more than 65°F. After installation, slowly increase the temperature a maximum of 5°F per 24 hour period. Temperatures should never exceed 85°F. **Warning:** Heating mats are not recommended for our WPC flooring.

EXPANSION GAPS: A minimum of 1/4" expansion gap must be allowed for **all** vertical obstructions including door jambs. If lengths or widths of installed areas of the product exceed 40 feet in any direction, a minimum of 3/8" expansion gap must be allowed for **all** vertical obstructions, including door jambs. Do not exceed 65 feet in any direction, even with the 3/8" expansion space without the approval of the technical sales department.

INSTALLATION TOOLS – necessary tools vary based on the width/installation method of the product but may include:

1. Tape measure
2. Tapping block (trimmed piece of flooring)
3. Pencil
4. Pry bar or pull bar
5. Chalk line
6. Crosscut power saw
7. 3M Scotch-Blue Tape 2080
8. Rubber mallet
9. White wood glue

Waterproof Click Installation & Maintenance

IMPORTANT REQUIREMENTS BEFORE INSTALLING:

- Take care to note the width and installation method of the product you're installing before moving on. Box ends will indicate the installation method and product width.
- Be certain a minimum of 1/4" expansion gap is allowed for **all** vertical obstructions including door jambs. If lengths or widths of installed areas of the product exceed 40 feet in any direction, a minimum of 3/8" expansion gap must be allowed for **all** vertical obstructions, including door jambs. Please check local building codes before undercutting metal door jambs.
- Be certain the subfloor is sound, flat, dry, and level. Floor levelness should not exceed 1/8" in a 6' radius span. Using a 6' or longer level or straightedge, slide along the subfloor looking for low and high areas, which must be either ground down or filled with an approved Portland based leveling compound. Abraham Linc is not responsible for flooring failures resulting from unsatisfactory subfloors.
- Wood subfloors must be secure making sure it is either nailed or screwed every 6" along the joists to avoid squeaking.
- Crawl spaces must have a black 6 to 20 mil thick moisture barrier **properly installed**. Moisture will not affect this product but it may permeate into the walls and structure of the building exposing you to problems with mold (and/or) mildew (and/or) excessive subfloor expansion/contraction.
- **Do Not** install this product where it will be in direct sunlight for extended periods of time.
- The manufacturer cannot be responsible for installing planks with visible defects.
- Existing floors such as ceramic, resilient tile and non-cushioned sheet vinyl must be well bonded to the subfloor. Do not sand existing vinyl floors, as they may contain asbestos.

Waterproof Click Installation & Maintenance

6" WIDE PRODUCT –ANGLE/TAP INSTALLATION ILLUSTRATIONS:

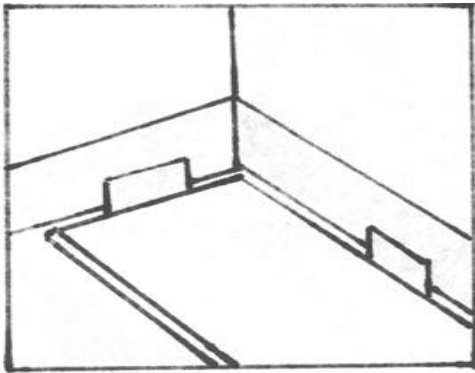

FIGURE 1

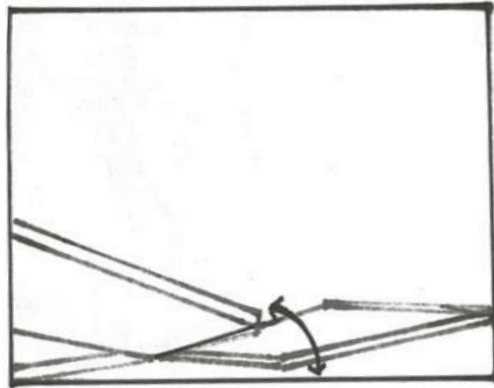

FIGURE 2

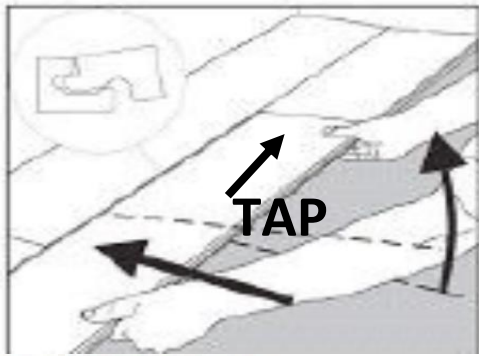

FIGURE 3

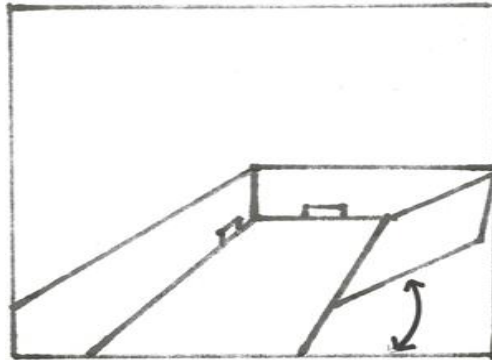

FIGURE 4

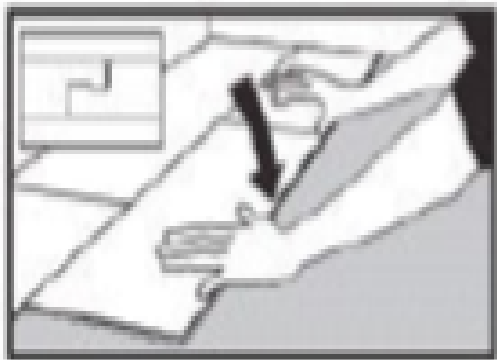

FIGURE 5

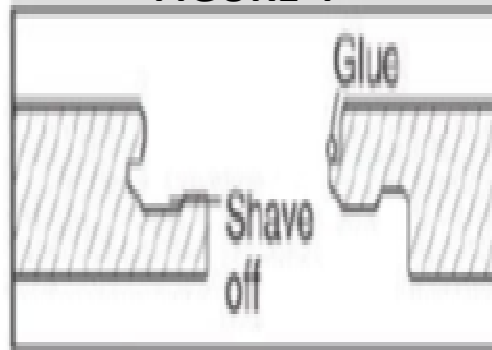

FIGURE 6

Waterproof Click Installation & Maintenance

6" WIDE PRODUCT – ANGLE/TAP INSTALLATION:

- Work from multiple cartons and “dry lay” several rows before beginning to install insuring duplicate planks are not installed beside each other.
- Measure the room to ensure that the last row will not be smaller than $\frac{1}{2}$ the width of the product. If so, rip the first row to accommodate the last row.
- Begin the first row working right to left. Insert minimum $\frac{1}{4}$ ” spacers around the perimeter of the room allowing for proper expansion space. See figure 1. The tongue should be facing the wall. Insert the next plank to the left and connect the short joint (figure 2) at an angle, ensure a complete connection between the two.
- Insert the second row by sliding the long joint tongue into the groove of the plank in the first row. Pull the plank towards the previously installed row until it is fully engaged. Install the second piece the same way, leaving a $\frac{1}{4}$ ” gap between the planks. Be certain to allow a minimum of 8” between end joints on the adjacent plank. The shortest starting or ending plank should not be less than 8” in length.
- Using a scrap piece of plank, align it to the left side of the second plank and lightly tap the scrap piece with a rubber mallet towards the first plank (figure 3). Do not tap the face or locking mechanism of the product with the rubber mallet without using a scrap piece.
- The piece closest to the wall can be installed using a wide ended pry bar to tap the pieces together.
- Install the remaining rows in the same manner (figure 5).
- Use cut pieces from a previous row as the starter board to reduce waste being certain it is at least 8” in length.

6" WIDE PRODUCT – ANGLE/TAP - INSTALLING THE FINAL ROW:

1. The last row may have to be cut (ripped) to properly fit the remaining width from the adjacent plank to the wall spacer. If necessary, complete the tight fit by tapping the board into place with a pull bar.
2. Place the last row of planks to be fit on top of the last row of installed planks. Use a piece of plank as a scribe to trace the contour of the wall. Mark it for a correct fit and cut.
3. After the boards are cut, position the planks and tighten the fit by using the pull bar.
4. If the last row is under a counter not allowing an angle click of the long joint, shave off the bottom of the groove and apply wood glue, then slip the tongue into the adjacent plank (figure 6). Wipe clean excess adhesive.

Waterproof Click Installation & Maintenance

6" WIDE PRODUCT – ANGLE/TAP - INSTALLING UNDER A DOOR JAMB:

1. Installation under moldings (such as door jambs) may require that the tip lip of the groove on the end be reduced in size.
2. Using a small plane or knife, carefully shave off the ledge of the groove (figure 6).
3. After the groove ledge has been trimmed, place the board in place and tighten with a pull bar to test for fit. The installer must be certain the require expansion of 1/4" has been maintained and the flooring is not pinched or tight. If the fit is not correct, re-trim as necessary.
4. Place a bead of wood glue on the bottom lip of the groove.
5. Insert the tongue into the groove and tighten the fit with a pull bar. Hold the board in place with painters tape (3M Scotch-Blue™ 2080 Tape) until the glue is dry. Do not use masking tape or duct tape as they may damage the floor's finish.

INSTALLING MOLDINGS (6" and 7" WIDE PRODUCTS):

- The manufacturer recommends using Cap-A-Treads for installation on steps. Cap-A-Treads and Cap-A-Risers can be purchase from your source for this product.
- All molding should be dry fit prior to flooring installation to ensure proper fit, finish, and match.
- Flush mount stair nose can be used to avoid tripping hazard. Follow the following instructions for flush mount stair nose installation.
 1. Moldings should always be dry fit prior to installing the floor to ensure floor/molding match.
 2. To accept the new flush mount stair nose the front of the step must be squared off by cutting the extended bull nose off, even with the riser, or by using a spacer to bring the riser out to cover the rounded front of the existing step.
 3. Once the step has prepped, cut the new stair nose to length and position tight against the riser. Remove the tongue of the adjacent piece of flooring where it will touch the stair nose.
 4. Dry fit the pieces and measure the area covered by flooring to ensure the last piece will be no less than ½ the width of the product. If not, you can tip the piece adjacent to the stair nose to accommodate.
 5. After dry fitting the nosing and planks to judge proper fit and finish, install the molding using high quality construction adhesive.
 6. After installing the molding, install the adjacent piece of floor using high quality construction adhesive. It is important that you only glue the piece adjacent to the stair nose and that you leave proper expansion space around all other fixed vertical obstructions, other than the stair nose. If the flooring touching the molding requires more than one piece, be sure that both all adjacent pieces are well adhered and properly locked together prior to the adhesive curing.

Waterproof Click Installation & Maintenance

7" WIDE – I4F ANGLE/DROP-LOCK – INSTALLATION ILLUSTRATIONS:

1 **PREPARE FLOOR**
Install on dry and level subfloor.

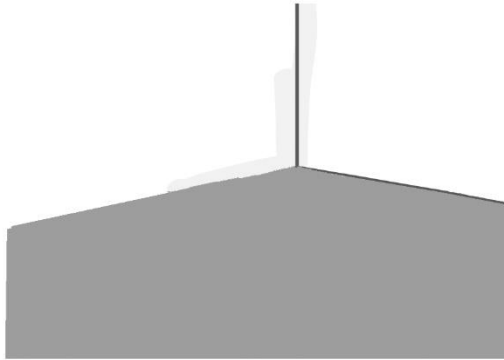

2 **SET SPACERS**
Place spacers equaling the thickness for required expansion gap between plank and wall on short and long ends of plank.

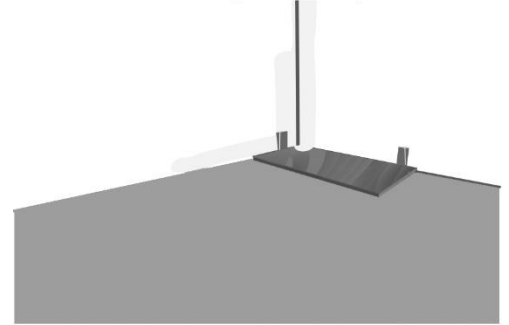

3a **SHORT SIDE - 3L TripleLock - One piece drop-lock system**

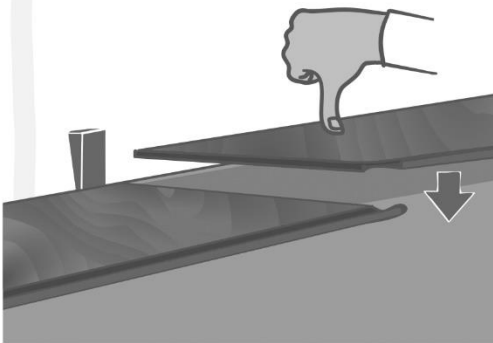

3b **Secure 3x locking**

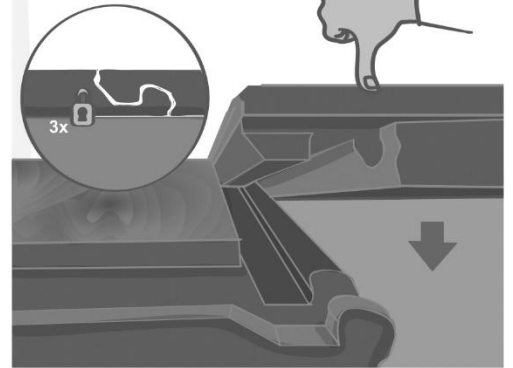

4 **LONG SIDE - Click4U - Angle-system**

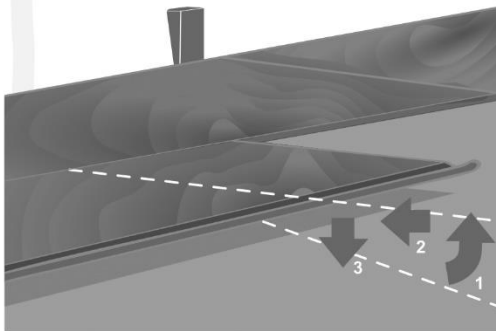

5 **Easy angle/drop-lock installation**

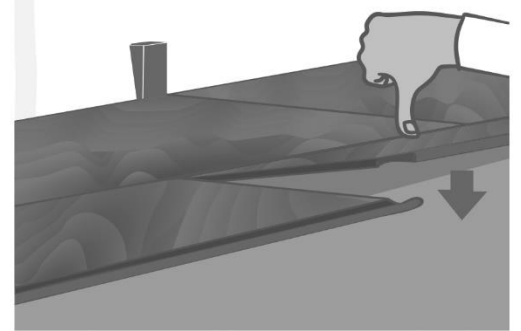

Waterproof Click Installation & Maintenance

7" WIDE – I4F ANGLE/DROP-LOCK - USING THE ANGLE/DROP-LOCK INSTALLATION:

- Work from multiple cartons and “dry lay” several rows before beginning to install insuring duplicate planks are not installed beside each other.
- Measure the room to ensure that the last row will not be smaller than ½ the width of the product. If so, rip the first row to accommodate the last row.
- Begin the first row working right to left. Insert minimum 1/4” spacers around the perimeter of the room allowing for proper expansion space, use 3/8” spacers if any run of material exceeds 40 linear feet, but does not exceed 65 linear feet. For installations exceeding 65 linear feet, please contact technical services. (Figure 2). The tongue should be facing the wall. Lay the next plank and connect the short joint (Figure 3 A/B) by placing it directly in the short side locking mechanism, ensure a complete connection between the two. Press the plank down until you hear an audible clicking sound.
- Insert the second row by sliding the long joint tongue into the groove of the plank in the first row. (Figure 4) Pull the plank towards the previously installed row until it is fully engaged. Install the second piece the same way, butting it to the first piece and engaging it the same way as the short side drop-lock in row one. Be certain to allow a minimum of 8” between end joints on the adjacent plank. The shortest starting or ending plank should not be less than 8” in length.
- If necessary, you can use a non-marring rubber mallet to gently tap the drop-lock mechanism together.
- Install the remaining rows in the same manner (figure 5).
- Use cut pieces from a previous row as the starter board to reduce waste being certain it is at least 8” in length.
- Any further questions on this product can be answered on www.I4F.com relating to 3L TripleLock and Click4U

Waterproof Click Installation & Maintenance

AFTER INSTALLATION:

- Furniture should be moved onto the newly installed floor using an appliance hand truck over hardboard runways.
- Avoid excessive exposure to direct sunlight.
- Indoor temperatures should always stay between 23° and 140° F. Significant temperature changes should be made gradually.
- Oil or petroleum-based products can result in surface staining. Do not track asphalt-driveway sealer or other oil based products on to the flooring. Use protected walk-off mats that are non-staining. Rubber may discolor the floor.
- Furniture should be equipped with felt pads to avoid scratching the floor. Heavy furniture and appliances should be equipped with non-staining large surface floor protectors. Furniture with wheeled castors should only have wide castors no less than 4" in diameter. Office areas must have a protective mat under chairs. DO NOT use ball-type castors.
- Floating floors must not be pinned with fixed cabinetry, heavy equipment or other heavy objects. This includes kitchen counters, slate pool tables, or other objects that would pin the floor from floating. If you have questions about a given piece of furniture, machinery, or otherwise heavy object, please contact technical services.
- Moldings from another flooring segment must not be nailed through the planks.
- Use walk-off mats at entrances to prevent dirt and grit from being tracked on to the floor.
- Sweep or vacuum the floor regularly to remove loose dirt. DO NOT use vacuums that use a beater bar or turn beater bar off.
- Damp mop as needed using clean water and a diluted neutral-PH floor cleaner. DO NOT use detergents, abrasive cleaners or "mop and shine" products. Use caution as with all smooth surface floors may become slippery when wet. Allow time for floor to dry after cleaning.